

Part Number: 113253

Part Description: Manual Valve, Fuel Storage Cylinder

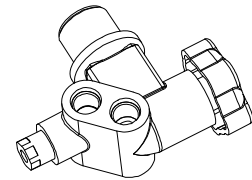

Product Technical Specifications

General Specifications

Manufacturer	OMB Saleri
Manufacturer PN	696UULXGU
Overall Length	4.1" (104.5 mm)
Approximate Handle Diameter	2.0" (51.2 mm)
Mass	2.0 lb (0.8990 kg)
Approved Service Gas	Compressed Natural Gas (CNG)
Certifications	NGV 3.1-1995, CGA 12.3-M95
Maximum Service Pressure	3600 psi (24.8 MPa) @ 70°F (21°C)
Temperature Range	-40°F (-40°C) to 180°F (82°C)
Seat Orifice Diameter	0.276" (7 mm)
Gas Flow	Not Available
Excess Flow Rating	Not Equipped

Electrical Characteristics

Voltage Range	N/A
Nominal Resistance @ 70°F (21°C)	N/A
Nominal Current Draw	N/A
Peak Current Draw	N/A

Electrical Interface

Solenoid Connector	N/A
Temperature Sensor Connector	N/A

Mechanical Interface

Cylinder Interface	1 1/8" -12 UNF-2A
Valve Body Material	Forged Brass
Inlet Port	9/16-18 UNF-2B
Outlet Port	9/16-18 UNF-2B
PRD Port	9/16-18 UNF-2B

Torque Specifications

Valve Interface	100 Ft. lb. (135 N.m.)
9/16 SAE Port Fittings (Recommended, refer to SAE J1926)	26 Ft. lb. (35 N.m.)

Maintenance Parts

Valve Interface O-Ring	Quantum PN 111409-216
------------------------------	-----------------------