

Part Number: 114056

Part Description: PRD Valve

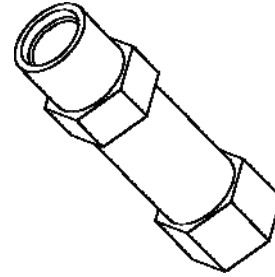

Product Technical Specifications

Approved Pressure Relief Device (PRD)

The specifications shown in this document outline the requirements of the PRD that has been tested and approved for use with your Quantum Type IV cylinder, valve, and PRD assembly.



DANGER Only approved PRD's are to be installed in your Quantum cylinder. Installation of a PRD not approved for your cylinder will result in death or serious injury.

Installation

This PRD must be installed on the cylinder before the cylinder is filled with fuel. Alteration or modification of a PRD is strictly prohibited.



WARNING This PRD is connected to a "live" port on the cylinder valve; this PRD will always be exposed to tank pressure even if the cylinder valve is in the closed position.

Never disassemble or disconnect the PRD from the cylinder while the cylinder is pressurized. Failure to follow this instruction may result in death or serious injury.

General Specifications

Manufacturer Information	Circle Seal 8100-44-BB
Activation Temperature	219°F (104°C)
Flow Orifice	Information Not Available
Normal Working Pressure	3600 psi (24.8 MPa)
Maximum Working Pressure	5000 psi (34.5 MPa)
Burst Disc Rating	N/A
Fuel	CNG
Operating Temperature	-40°F–185°F (-40°C–85°C)
Certification	ANSI PRD-1
Inlet Port Thread	3/4-16 SAE Female
Discharge Port Thread	3/4-16 SAE Female
Torque (3/4-16 SAE)	41 Ft. lb. (55 N.m.)
Build Material	Nickel-Plated Brass

