

Part Number: 113858

Part Description: Manual Valve, Fuel Storage Cyl

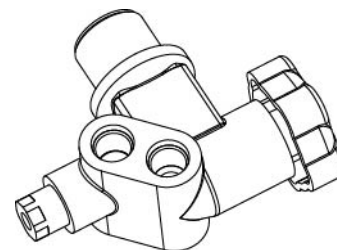

Product Technical Specifications

General Specifications

Manufacturer	OMB Saleri
Manufacturer PN	696UULAGQTH
Overall Length	4.4" (111 mm)
Approximate Handle Diameter	2.0" (52 mm)
Mass	2.0 lb (0.9 kg)
Approved Service Gas	Compressed Natural Gas (CNG)
Certifications	NGV 3.1-1995, CGA 12.3-M95, ANSI/IAS PRD 1a-1998/1999, ANSI/IAS PRD1b-2007, ECE-R110, ISO 15500
Service Pressure	3,600 psi (24.8 MPa) @ 70°F (21°C)
Temperature Range	-40°F (-40°C) to 180°F (82°C)
PRD Activation Temperature	226.4°F ±10.8°F (108°C ±6°C)
Seat Orifice Diameter	0.276" (7 mm)
PRD Orifice Diameter	0.315" (8 mm)
Excess Flow Rating	N/A
Burst Disc	N/A

Electrical Characteristics

Voltage Range	N/A
Nominal Resistance @ 70°F (21°C)	N/A
Nominal Current Draw	N/A
Peak Current Draw	N/A

Electrical Interface

Solenoid Connector	N/A
Temperature Sensor Connector	N/A

Mechanical Interface

Cylinder Interface	1 1/8" -12 UNF-2A
Valve Body Material	Forged Brass
Inlet Port	9/16-18 UNF-2B
Outlet Port	9/16-18 UNF-2B
PRD Discharge Port	9/16-18 UNF-2B
PRD Live Port* (2x)	N/A

Live port refers to a valve port that cannot be shut off by the use of the valve shut off mechanism; this port of the valve is connected directly to the cylinder contents.

Torque Specifications

Valve Interface	100 Ft. lb. (135 N.m.)
9/16 SAE Port Fittings (Recommended, refer to SAE J1926)	22 Ft. lb. (30 N.m.)

Maintenance Parts

Valve Interface O-Ring	Quantum PN 111409-216
------------------------------	-----------------------